

123 Brice Rd, Kittanning, PA 16201-3405, Armstrong County

	Beds <b>4</b>	Bldg Sq Ft <b>1,440</b>	Lot Sq Ft <b>N/A</b>	Sale Price <b>N/A</b>
	Baths <b>2</b>	Yr Built <b>2004</b>	Type <b>SFR</b>	Sale Date <b>N/A</b>

**OWNER INFORMATION**

Owner Name	<b>S &amp; T Bank</b>	Tax Billing Zip	<b>15701</b>
Owner Occupied	<b>No</b>	Tax Billing Zip+4	<b>3908</b>
Tax Billing Address	<b>800 Philadelphia St</b>	Carrier Route	<b>C001</b>
Tax Billing City & State	<b>Indiana, PA</b>		

**LOCATION INFORMATION**

Township	<b>East Franklin Twp</b>	Zoning	<b>AC</b>
School District	<b>Armstrong SD</b>	Topography	<b>Above Street</b>
Neighborhood Code	<b>1200000-1200000</b>	Flood Zone Code	<b>X</b>
Census Tract	<b>9505.00</b>	Flood Zone Date	<b>02/17/2016</b>
Carrier Route	<b>R003</b>	Flood Zone Panel	<b>42005C0305D</b>

**TAX INFORMATION**

Tax ID	<b>12-0-005706</b>	% Improved	<b>86%</b>
Alt. Tax ID	<b>117000143</b>	Annual Tax	<b>\$3,633</b>
Parcel ID	<b>120005706</b>	County Tax	<b>\$825</b>
Block #	<b>1</b>	Township Tax	<b>\$250</b>
Tax Area	<b>12</b>	School Tax	<b>\$2,559</b>
Legal Description	<b>.42A IMPRS.</b>		

**ASSESSMENT & TAX**

Assessment Year	2020	2019	2018
Assessed Value - Total	<b>\$43,405</b>	<b>\$43,405</b>	<b>\$43,405</b>
Assessed Value - Land	<b>\$6,000</b>	<b>\$6,000</b>	<b>\$6,000</b>
Assessed Value - Improved	<b>\$37,405</b>	<b>\$37,405</b>	<b>\$37,405</b>
YOY Assessed Change (\$)	<b>\$0</b>	<b>\$0</b>	
YOY Assessed Change (%)	<b>0%</b>	<b>0%</b>	
Market Value - Total	<b>\$86,810</b>	<b>\$86,810</b>	<b>\$86,810</b>
Market Value - Land	<b>\$12,000</b>	<b>\$12,000</b>	<b>\$12,000</b>
Market Value - Improved	<b>\$74,810</b>	<b>\$74,810</b>	<b>\$74,810</b>
Tax Year	Total Tax	Change (\$)	Change (%)
2018	<b>\$3,640</b>		
2019	<b>\$3,644</b>	<b>\$4</b>	<b>0.12%</b>
2020	<b>\$3,633</b>	<b>-\$11</b>	<b>-0.3%</b>

**CHARACTERISTICS**

Land Use - County	<b>Residential</b>	Bath Fixtures	<b>7</b>
Land Use - CoreLogic	<b>SFR</b>	Total Rooms	<b>7</b>
Lot Acres	<b>0.42</b>	Heat Type	<b>Unit Heaters</b>
Style	<b>Colonial</b>	Water	<b>Well</b>
Year Built	<b>2004</b>	Sewer	<b>Septic Tank</b>
# of Buildings	<b>1</b>	Basement Type	<b>Full</b>
Stories	<b>2</b>	Exterior	<b>Aluminum/Vinyl</b>
Living Area	<b>1,440</b>	Condition	<b>Good</b>
Bedrooms	<b>4</b>	Parking Type	<b>Detached Frame/Concrete Block</b>
Full Baths	<b>1</b>	Garage Type	<b>Detached Garage</b>
Half Baths	<b>1</b>	No. of Porches	<b>1</b>
Total Baths	<b>2</b>	Porch	<b>Open Frame Porch</b>

**FEATURES**

**Property Details**

The data within this report is compiled by CoreLogic from public and private sources. If desired, the accuracy of the data contained herein can be independently verified by the recipient of this report with the applicable county or municipality.

Feature Type	Unit	Size/Qty	Width	Depth	Year Built
Main Dwelling	S	720			
Open Frame Porch	S	70			
Frame Or Cb Detached Garage	S	320	16	20	1998

SELL SCORE			
Rating	Moderate	Value As Of	2020-07-13 23:10:38
Sell Score	529		

LAST MARKET SALE & SALES HISTORY			
Owner Name	S & T Bank	Document Number	954-68
Seller	Owner Record	Deed Type	Deed (Reg)

Sale/Settlement Date	08/22/2019		
Recording Date	08/22/2019		
Sale Price	\$11,497		
Buyer Name	S & T Bk	Walker Jimmy D & Margaret J	
Buyer Name 2		Walker Margaret J	
Seller Name	Sheriff Of Armstrong County	Owner Record	
Document Number	5234-214	954-68	
Document Type	Sheriff's Deed	Deed (Reg)	

MORTGAGE HISTORY			
Mortgage Date		12/31/2015	
Mortgage Amount		\$50,000	
Mortgage Lender		S&T Bk	
Mortgage Code		Conventional	

FORECLOSURE HISTORY			
Document Type		Notice Of Sale	
Recording Date		05/06/2019	
Final Judgment Amount		\$48,156	
Original Book Page		954000068	
Lender Name		S & T Bk	
Foreclosure Case #		2019-294	

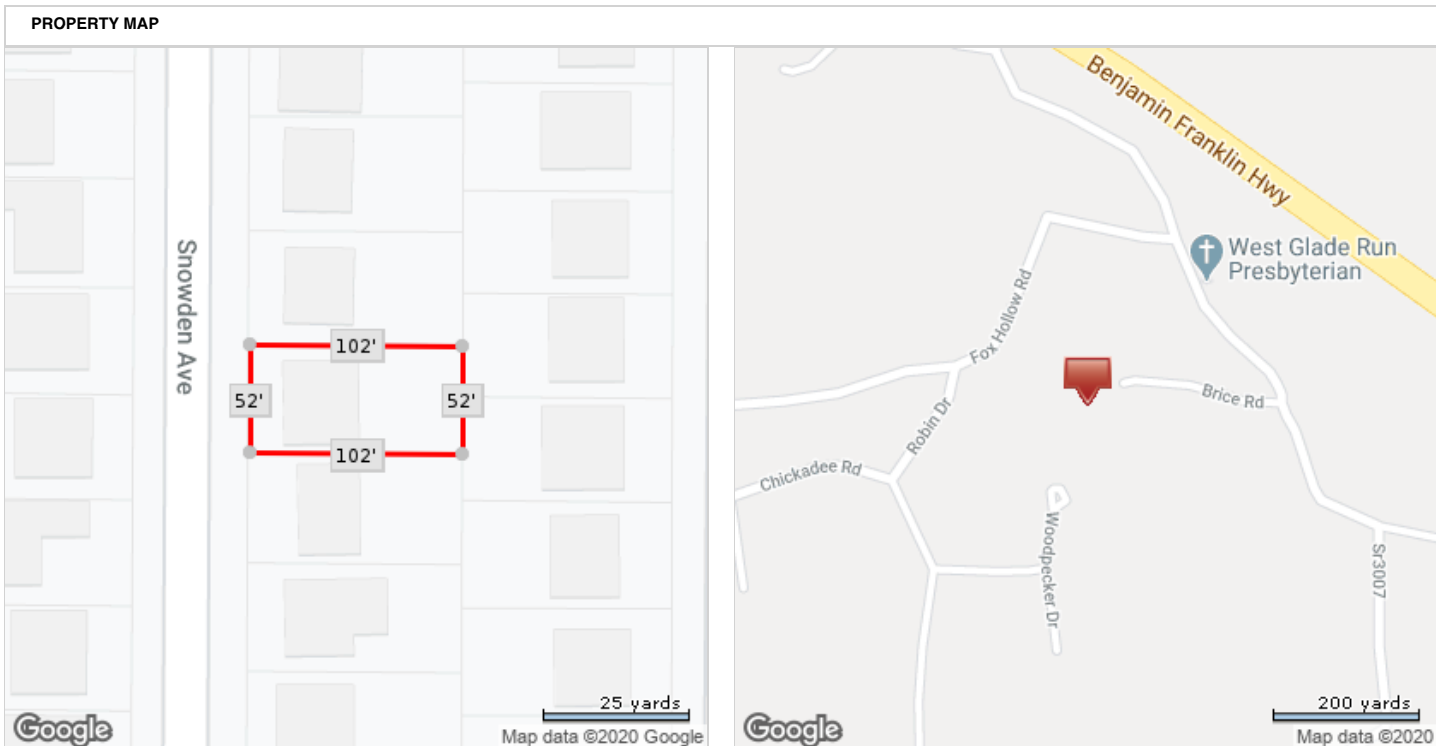

\*Lot Dimensions are Estimated

**Property Details**

The data within this report is compiled by CoreLogic from public and private sources. If desired, the accuracy of the data contained herein can be independently verified by the recipient of this report with the applicable county or municipality.

Generated on: 07/16/20

Page 2/2