

148 Cannel Mine Rd, New Bethlehem, PA 16242-7706, Armstrong County

	Beds	Bldg Sq Ft	Lot Sq Ft	Sale Price
	3	1,344	N/A	\$120,000
	Baths	Yr Built	Type	Sale Date
	2	1978	SFR	01/31/2014

OWNER INFORMATION			
Owner Name	S & T Bk	Tax Billing Zip	15701
Owner Occupied	No	Tax Billing Zip+4	3908
Tax Billing Address	800 Philadelphia St	Carrier Route	C001
Tax Billing City & State	Indiana, PA		

LOCATION INFORMATION			
Subdivision	Ronald W Truitt	Carrier Route	R001
Township	Mahoning Twp	Topography	Flat/Level
School District	Redbank Valley SD	Flood Zone Code	X
Neighborhood Code	2800000-2800000	Flood Zone Date	02/17/2016
Census Tract	9501.00	Flood Zone Panel	42005C0227D

TAX INFORMATION			
Tax ID	28-0-019310	% Improved	79%
Alt. Tax ID	051000106	Annual Tax	\$1,453
Parcel ID	280019310	County Tax	\$567
Lot #	B	Township Tax	\$149
Tax Area	28	School Tax	\$737
Legal Description	.571A & IMPRS.		

ASSESSMENT & TAX			
Assessment Year	2020	2019	2018
Assessed Value - Total	\$29,830	\$29,830	\$29,830
Assessed Value - Land	\$6,355	\$6,355	\$6,355
Assessed Value - Improved	\$23,475	\$23,475	\$23,475
YOY Assessed Change (\$)	\$0	\$0	
YOY Assessed Change (%)	0%	0%	
Market Value - Total	\$59,660	\$59,660	\$59,660
Market Value - Land	\$12,710	\$12,710	\$12,710
Market Value - Improved	\$46,950	\$46,950	\$46,950
Tax Year	Total Tax	Change (\$)	Change (%)
2018	\$1,376		
2019	\$1,415	\$39	2.84%
2020	\$1,453	\$38	2.68%

CHARACTERISTICS			
Land Use - County	Residential	Fireplace	Y
Land Use - CoreLogic	SFR	Fireplaces	1
Lot Acres	0.571	Heat Type	Hot Water Steam
Style	Ranch	Water	Well
Year Built	1978	Sewer	Septic Tank
# of Buildings	1	Basement Type	Full
Stories	1	Exterior	Frame
Living Area	1,344	Condition	Fair
Bedrooms	3	Parking Type	Detached Frame/Concrete Block
Full Baths	1	Garage Type	Detached Garage
Half Baths	1	No. of Patios	1
Total Baths	2	Patio Type	Wood Deck
Bath Fixtures	7	No. of Porches	1
Total Rooms	6	Porch	Enclosed Frame Porch

Property Details

The data within this report is compiled by CoreLogic from public and private sources. If desired, the accuracy of the data contained herein can be independently verified by the recipient of this report with the applicable county or municipality.

FEATURES					
Feature Type	Unit	Size/Qty	Width	Depth	Year Built
Main Dwelling	S	1,344			
Encl Frame Porch	S	336			
Wood Deck	S	480			
Frame Or Cb Detached Garage	S	784	28	28	1978

SELL SCORE			
Rating	Very Low	Value As Of	2020-07-13 23:10:38
Sell Score	238		

LAST MARKET SALE & SALES HISTORY			
Sale Date	01/31/2014	Seller	Truitt Ronald W
Recording Date	01/31/2014	Multi/Split Sale	Multiple
Sale Price	\$120,000	Document Number	4556-12
Owner Name	S & T Bk	Deed Type	Deed (Reg)

Sale/Settlement Date	02/19/2020	01/31/2014	
Recording Date	02/19/2020	01/31/2014	
Sale Price	\$1,039	\$120,000	
Nominal	Y		
Buyer Name	S & T Bk	Saylor Joel L & Patricia L	Truitt Ronald W
Buyer Name 2		Saylor Patricia L	
Seller Name	Sheriff Of Armstrong County	Truitt Ronald W	Owner Record
Multi/Split Sale Type	Multi	Multiple	Multi
Document Number	5289-170	4556-12	933-173
Document Type	Sheriff's Deed	Deed (Reg)	Deed (Reg)

MORTGAGE HISTORY			
Mortgage Date	01/31/2014	04/30/2012	
Mortgage Amount	\$96,000	\$112,750	
Mortgage Lender	S&T Bk	Cnb Bk	
Mortgage Code	Conventional	Conventional	

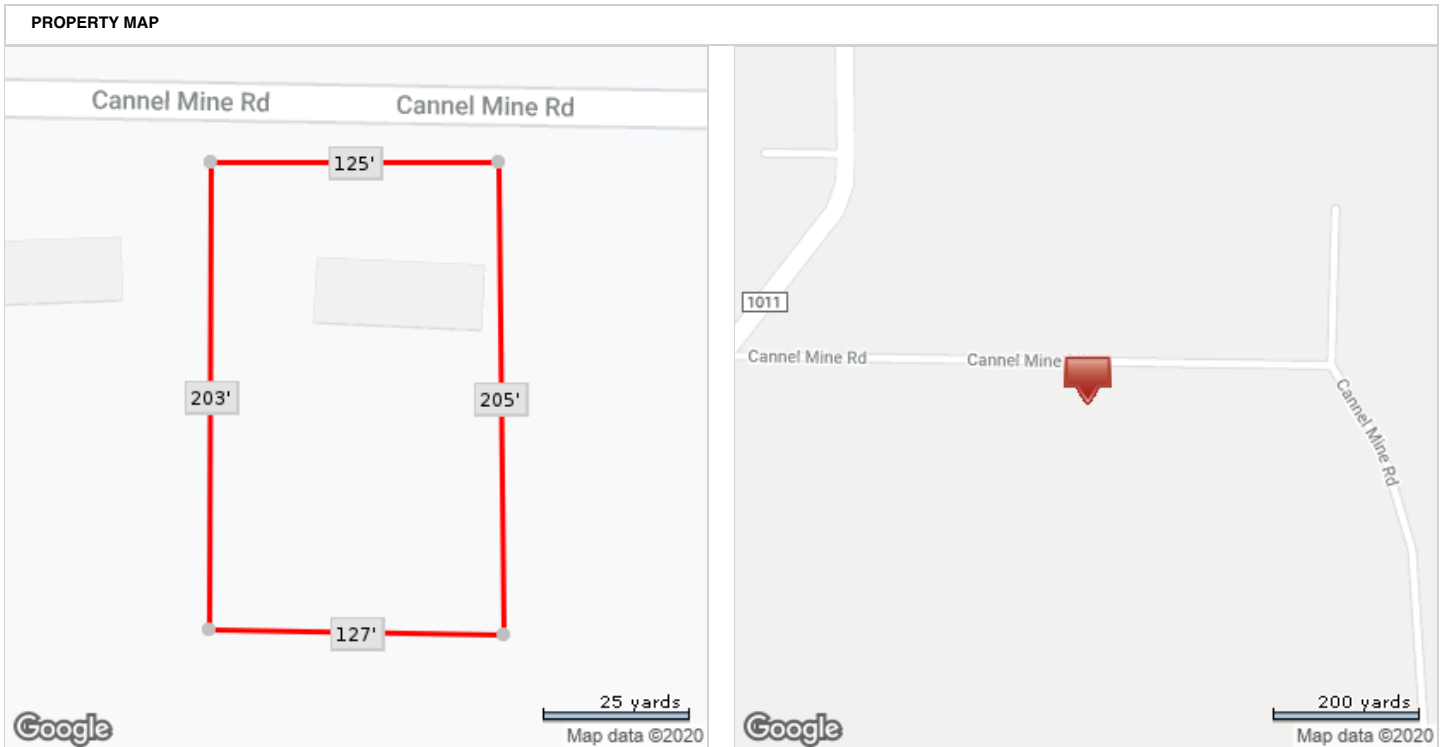

*Lot Dimensions are Estimated

Property Details

The data within this report is compiled by CoreLogic from public and private sources. If desired, the accuracy of the data contained herein can be independently verified by the recipient of this report with the applicable county or municipality.